

Jonathan Hunt

ESTATE AGENCY

20 High Street Ware SG12 9BX

Tel: 01920 411090

8 High Street Buntingford SG9 9AG

Tel: 01763 272727

info@jonathan-hunt.co.uk

www.jonathanhunt.co.uk



5 Sele Mill, North Road, Hertford, Hertfordshire, SG14 1LD

£249,995

JONATHAN HUNT are very pleased to offer this one bedroom GROUND FLOOR apartment located within a private gated development just a short walk to Hertford North British Rail and Hertford town centre. The property also offers allocated parking and communal gardens. CHAIN FREE

Buntingford Branch - Company No. 10303541 VAT No. 10303541

Ware Branch - Company No. 4759215 VAT No. 700174975

5 Sele Mill, North Road, Hertford, Hertfordshire, SG14 1LD

ENTRANCE HALLWAY

LIVING AREA 21'3" x 11'0" (6.5 x 3.36)

KITCHEN AREA

DINING

BEDROOM 12'5" x 11'3" (3.8 x 3.43)

BATHROOM



Energy Efficiency Rating		
	Current	Potential
Very energy efficient - lower running costs		
(92 plus) A		
(81-91) B		
(69-80) C		
(55-68) D		
(39-54) E		
(21-38) F		
(1-20) G		
Not energy efficient - higher running costs		
England & Wales	EU Directive 2002/91/EC	

Environmental Impact (CO ₂) Rating		
	Current	Potential
Very environmentally friendly - lower CO ₂ emissions		
(92 plus) A		
(81-91) B		
(69-80) C		
(55-68) D		
(39-54) E		
(21-38) F		
(1-20) G		
Not environmentally friendly - higher CO ₂ emissions		
England & Wales	EU Directive 2002/91/EC	

Ground Floor

Approx. 47.5 sq. metres (511.3 sq. feet)

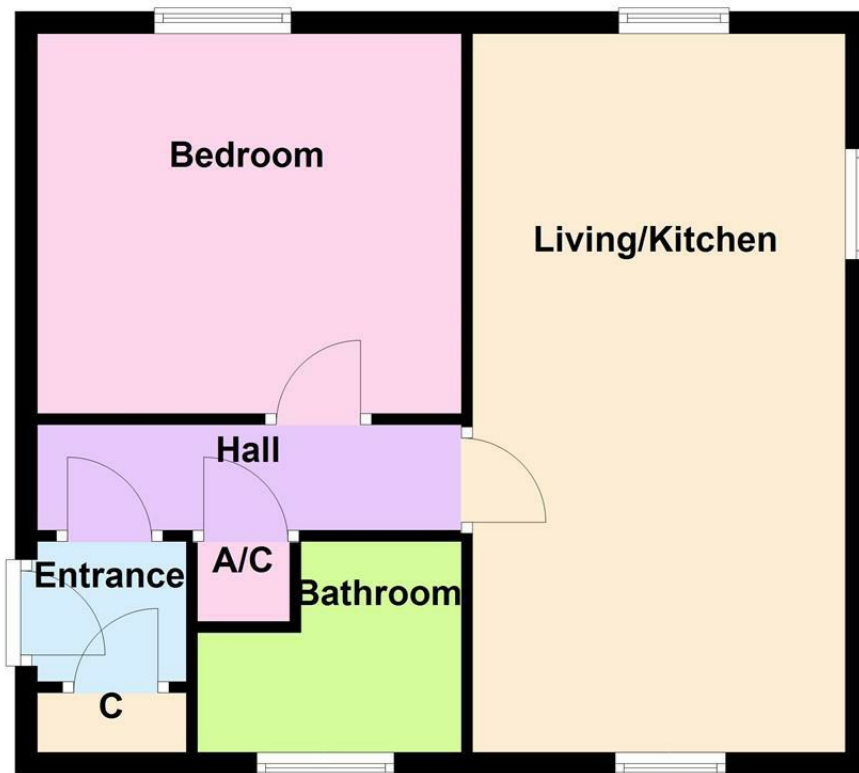

Total area: approx. 47.5 sq. metres (511.3 sq. feet)

Whilst every attempt has been made to ensure the accuracy of the floor plan contained here, measurements of doors, windows, rooms and any other item are approximate and no responsibility is taken for any error, omission, or misstatement. This plan is for illustrative purposes only and should only be used as such by any prospective purchaser.

Plan produced using PlanUp.